

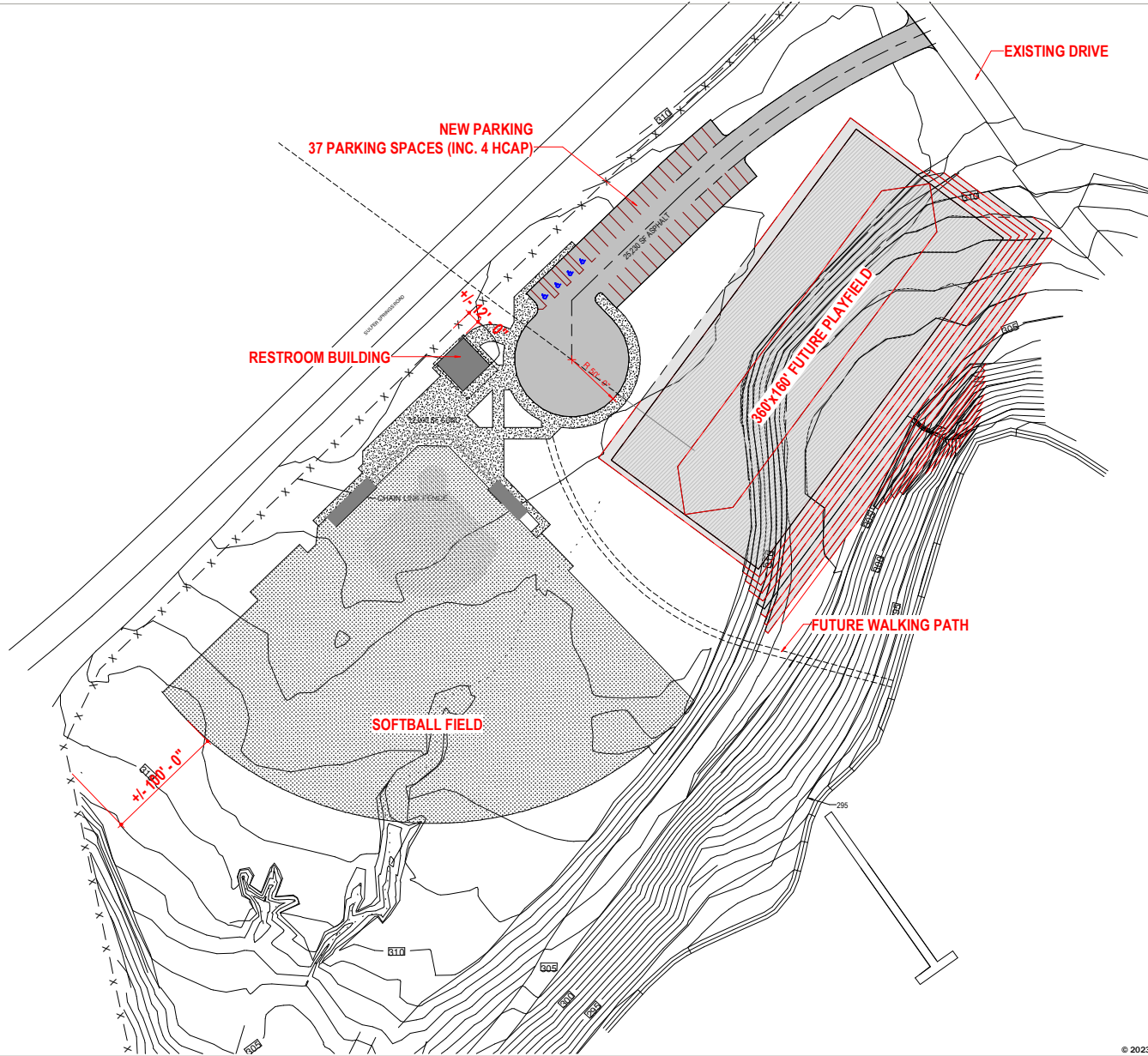

1

SITE PLAN

1" = 40'-0"



Revisions:

Project:	JMU
Lead:	2/2022B
Project:	SEPT 22
Date:	JMU
Drawn:	JMU
Checked:	JMU

These drawings are the property of the firm and are not to be reproduced or used in any way without the written consent of the firm.

SULPHUR SPRINGS PARK SOFTBALL FACILITY
MADISON COUNTY BOARD OF SUPERVISORS

929 SULPHUR SPRINGS ROAD CAMDEN, MS 39045

SITE PLAN

AS101

© 2023

FOR PRINT SCALE VERIFICATION THE TITLEBLOCK OPENING IS 23" X 32.5"